

According to "Pension Records of Soldiers of the Revolution who removed Florida", by Jessie Roberson Fritot, p. 41, Joseph Singletary was born June 9, 1761, and died before Oct. 5, 1844, and was nursed by Mary Ann Singletary. The records of the Poplar Springs Primitive Baptist Church of Thomas County indicate that he died April 14, 1844. He was a charter member of this church in 1840, having transferred from the Tired Creek Church of Decatur County, which he joined in ~~1835~~, <sup>MAR 4, 1837</sup> together with MARY.

In the July, 1844, term of the Thomas Co., GA, Court, Letters of Administration were granted to Josiah Singletary to administer the estate of Joseph Singletary. He supplied Letters of Administration, and posted \$500 bond, p. 105, 1837-1849 Minutes Book of Thomas County.

After appraisal by men who were all his relatives, and the sale of his property, the following were his heirs - (Josiah, though the administrator, did not inherit. I believe this to be because the land was in his name and there was very little else).

Feb. 13, 1845, pd. from estate of Joseph Singletary:

Shadrack Posey, \$5.00, son-in-law m. Sarah 12-28-1838

Mary Singletary, \$5.00, (nurse-wife ?) perhaps daughter ?

Nancy Singletary, \$5.00, wife of Josiah

Isaac Boyett, son-in-law m. Margaret Singletary

Nathaniel Singletary, \$5.00

Henry Singletary, \$5.00

William Singletary, \$5.00

~~Will McKinnon, \$7.93, son-in-law~~

The land which Josiah bought in 1835 in Thomas Co., GA was held by him until 1854, when it was conveyed to Harrison Singletary, son of Brayton 1795-1853, who may have been Joseph's son also. This land lies in what is now Grady County, and is south of U. S. 84 to Thomasville, on what was long ago known as the Singletary Road. All those who held property in Leon County, FLA, lived in the same area with the exception of Brayton who held land in various other parts of the county as well.

There were in Leon or adjoining counties, the following persons between 1825 and 1837 in addition to Joseph Singletary, Revolutionary Soldier:

1. Brayton Singletary 1795-1853, in FLA 1821 to Thomas Co., GA 1838.
2. Benjamin - <sup>plc 1843</sup> ~~1847~~, died Leon Co., FLA, wife Sarah 1833 heirs: Leonard, Susan McDaniel, minors - Joseph, Henry and Brayton.
3. Nathaniel Singletary and first wife Nepsy 1833. Son<sup>d</sup> Joseph. ~~etc.~~
4. Nathaniel Singletary married <sup>pl</sup> Martha Ann Singletary 1835 in Leon Co. and moved to Decatur Co., GA 1838.
5. Henry, son Joseph<sup>ns</sup>, wife Hannah in 1835, to Inomas Co., GA prior 1840.
- \* 6. Harrison witnessed for Benjamin 1831, m. Sarah High 1832, d. FLA, ~~1851~~ leaving minor Margie Ann. <sup>5</sup> JULY 28, 1838

7. Sarah m. Henry Miller 1835, to GA. Dec. Co. 1839
8. Edward m. Eliza Loch 1833, Leon Co.
9. Nelson witnessed for Brayton 1835, to Thomas Co., GA. believed son of Benjamin
10. Josiah witnessed for Henry, 1833. Josiah was living with father, Revolutionary Soldier Joseph, so was not Head of Household.
11. Isaac Boyett witnessed 1833, husband Margaret Singletary.

Conclusions and additions, Jan, 1978

1. Brayton Singletary had arrived from N.C. and brought land in Leon Co Oct 14, 1828. At this time, James B. Singletary was already a member of the Trust Creek Prais. Bapt. Church of Decatur Co, Ga. <sup>18<sup>th</sup> Br</sup> Wm. Hawthorne testified that he knew Joseph Singletary to be a h. Solo Isaac + Margaret Boyett, Joseph's daughter, lived in Dec. Co and all indications are, that they moved back + forth in Leon, THOS + Dec Co's. Frequently. James B, who went to THOS Co. later, is believed to be son of Ithamar, P.S.
2. In BSA Records, Natl. Archives obtained from Washington DC, correspondence between Fla. officials + U.S. Commissioners of Pensions indicate not only mistakes but that his certificate of eligibility was lost for several years. After much correspondence he received his pension for 3 years in 1838. His records are further complicated by Susannah Singletary being listed as his wife by early researchers. New depositions <sup>from</sup> April Feb 23, 1833 in Leon Co. Fla states "said Singletary lay three or four months, severely wounded, at the house of the mother of this deponent, during which time deponent assisted in nursing ~~him~~ the said Singletary" No mention of her as wife.
3. There is a Joseph Singletary in Bladen Co. 1820, of the right age group. It may be that he was left at home while his children went ahead into what was then a wilderness.
4. In a letter to the Commission of Pensions in June 1837, R.G. Wetford of Tallahassee, agent for R.S. Joseph Singletary gave Joseph's address as Thomasville, Ga.
5. Harrison Singletary did not remove to Georgia as did the others. <sup>28 July, 1838,</sup> On the day that he returned from his 3<sup>rd</sup> enlistment with the Florida Militia, covering more than two years, he and his family were massacred by the Seminole Indians. His four year old daughter Mary Ann escaped. Pension testimony says that her parents and two youngest children were killed, and the house

BRAYTON SINGLETARY 1795-1854 N.C., FLA. GA.  
 1st wife \_\_\_\_\_ m N.E. c 1817 d c  
 1. William b.c. 1819<sup>nc</sup> m Susan Wood TO TX 1851  
 2. Nancy b 1821 N.C. m Jos. Singletary son Willis son R.S. JOSIAH  
 3 John dsp. n.c.  
 4 Susan b 1822 n.c. m JOHN BRYAN son Philemon <sup>which one</sup>  
 5 Benjamin <sup>BRYAN</sup> b 1825 m Frances Wood TO TX 1851  
 6. DAVID ? b. Fla. 1826  
 7. HARRISON b. Fla 1829 Fla. m. SARAH JAMES. DAU DAVID-JESSE.  
 \* 8 WILLIS 1832 b. Fla died CSA 1864 m Narcissus Rawls  
 NARCISSUS SECOND MARRIAGE TO GREEN BERRY S. son  
 of WILLIS son of DAVID-JESSE  
 2<sup>d</sup> WIFE BRAYTON - NEPSY (b 1818) SINGLETARY 1849  
 MARGY ANN - SNOWDEN  
 WIVES OF 1 + 5 sisters dau's Jos. Wood + Amelia (dau R.S. Singletary)

\* JOHN BRYAN<sup>5</sup> (son Philemon<sup>4</sup>) which one?  
 b. 1819 N.C. d. 1875 HAMCO Fla.  
 m. SUSAN SINGLETARY THOS. CO. GA (DAU BRAYTON 1795-1854)  
 b 1822 N.C. d. TASPEN FLA 1890  
 HARRISON b. 1845 d. C.S.A FLA  
 VASHTI b 1847 m. Jos. Harvis  
 HARDY b. 1850 m. Virginia Duncan  
 FRANCES m. Wm. Sandlin  
 NOAH dy.  
 MARY b 1858 m. Samuel Register  
 FLORENCE m. JOHN SMITH  
 Thomas,<sup>1</sup> ~~Philemon~~,<sup>2</sup> Wm.<sup>3</sup> Philemon,<sup>4</sup> John<sup>5</sup>  
 Husband has written quite a bit about him -  
 bro. of Nathan, my husband's great-grandfather

\* HENRY MILLER  
 b c 1805 GA ? d c 1868 THOS CO GA  
 m. SARAH SINGLETARY b.c. 1808 N.E. m. 1835 Leon Co. Fla  
 \* SONN JEFFERSON born Fla 1836 m. LOUISA E. BAILEY d. CSA  
 MARY JANE " " e 1837 m. Francis P. Hawthorne (d. CSA)

THOMAS BRYAN d. 1767 (Feb 25, 1760) BRADEN CO.

STEPHEN

WM, b. 1757 m. SARAH SINGLETARY - PHILEMON - <sup>Sept 1843</sup> PHILEMON - <sup>also w m b. 1794</sup> JOHN

DWARD 3 sons, no heirs white? ?

THOS. d. 1786 <sup>1757</sup> ?

PHILEMON (50) <sup>father w m b. 1757</sup> ? <sup>uncle wife</sup> ?

SARAH SIMPSON <sup>1781</sup> m. David Singletary son Jesse to T.C. 1841?

EMZ. O  
ARMY BALDWIN

EX Edw Bryan

3

WM. Bryan b. 1757 <sup>Philemon son</sup> d. 1838 <sup>Bladen Co</sup>

M SARAH (SINGLETARY?) <sup>son Philemon son Thos.</sup>

Philemon b. 1779 m Nancy <sup>Fluore</sup> FLA born 1830 <sup>1840</sup>

1781 ? <sup>d. prior 1840 Nancy's wid. 1840 census</sup>

1784 Sarah Evers

1787 m. Tomler to FLA HAMILTON CO 1840

1788 m. John White

1790 Sophia Simpson

1795 Susann Simpson to FLA, HAM CO - 1849 to GA

1799 ?

1801 Margaret Allen Remained N.C.  
<sup>w m Tomler m. dau. Sarah</sup>

NATHAN (184) <sup>TO FLA - GA ?</sup> <sup>(Columbus Co. Rec after 1808)</sup>

1801 m. Mary Singletary

PHILEMON BRYAN <sup>son Thos</sup>

WILLIAM <sup>is THIS w m. S. b. 1798 m. I.</sup>

PHILEMON <sup>IN 1840 HAMILTON CO ADJ NANCY P.</sup>

SARAH

SUSANNAH m Noble Smith ?

NATHANIEL? <sup>IN FLA & GA w R.S. SO</sup>

JOHN BRYAN d. same as 1774 <sup>Bladen</sup>

wife Same <sup>son Thos.</sup>

JOHN

PHILMORE

JAMES

ANN

EX THOS OWEN

WIT JOHN OWEN WM BRYAN

1850 #283 THOS CO GA

2501 son NOBLES + SUSANNAH  
b. 1815 with ~~Sarah~~ <sup>FRYAN.</sup>

1. David Singletary 1856 b. FLA.

roy (12f) son Lem S + Sidney "

" " " b. Ga

" " " "

" " " "

m. Matilda Treys sister,  
(w m S + Sidney's)

" " " "

Grandson sons Benjd FLA.

v. Grove Community also David  
+ SOPHIA SINGLETARY

#565 THOS. 1860

b n.c  
Fla

" "

Ga

↓

m Matilda S.

Lab

SARAH SINGLETARY (widow David) #907 1860 THOS CO

age 70 WITH WARREN 1650000.63 b. N.C.

FRANONE 24 M farmer 400 "

ELIZ. SMITH 37 wid ~~FRANONE~~ <sup>FRANONE</sup> ~~FRANONE~~ FLA?

huey " 21 widw Tyron Smith, son NOBLES "

Solu " 19 " "

Abigail " 15 FGA.

William " " GA

ELIZ. SMITH 200, 300

SARAH mother of Warren, David, Haynes, Willis, Edw. Simpson,  
Travis, Sarah Jane, Tom. 5 and several daughters

DAVID TO THOS. CO GA (direct) from Bladen county

pp. 110 ~~THOS~~ LATE 30s. BOUGHT LAND 1841

SARAH SINGLETARY widow David son <sup>SESSE THOS CO</sup> ~~Johann~~ 1870

82 (mother Warren, Travis, David, Sarah Jane) b. N.C.

\*NEPSY 52 widow BRAYTON 1795-1853 NC.

Snowden 18 son " " n.m. GA

Nepsy possibly dau Rich Undated Bladen Will - Sydney,  
prob dau Rich, undated will m Lem. T. Singletary 1838  
THOS. CO. GA.

+ Sarah's dau. Sarah Jane m  
Harrison, BRAYTON'S SON -

\*NEPSY, BRAYTON'S 2<sup>d</sup> WIFE (1849)

Sarah Jane's mother + the woman's ~~Sarah Jane~~

WM. J. BRYAN 1850 #284 THOS CO.  
 age 52 b 1798 d. c. 1870 THOS. CO (b 1802) b. N.C.  
 MARY (SINGLETERY) 48 →  
 SARAH (Ann) 22 m. Warren Singletary "   
GR. SON R.S. S.D.S. 1852  
 MARY b. Aug 18, 1830 - 1886 17 m. Alex. Singletary FIA  
 SUSAN nm lived w. Isabel, niece 16 (Aldridge) "  
 MALINDA HELEN? 13 m. H "  
 JOHN (Q) m. Caledonia Walker 10 → Aunt Alice GA  
 " Mother Miller"

ALICE S. BRYAN 1850 # 211, widow Ne THOS. CO.  
 (nee SINGLETERY) 57 farmer 100 A  
 Ann 20 F (b. Fla  
 SARAH 19 F (b Fla  
 NATHANIEL 16 M

321

Helen m. Haynes Singletary 3-5-1846

Aunt Alice is closer kin to Callie S. Miller than to Frank E. Miller?  
 not Hardy son Selu Hill d  
 HAD BRO: TRAVIS BRYAN → HARDY - CALLIE CHESTER 1826

MARY (BRYAN) SINGLETERY wid. Alexander, d. 1858 <sup>HH 351-362</sup> 1880 THOS  
 Age 49 dau. Wm J. + Mary Singletary BRYAN  
 Birthplace Parents ALL N.C.  
 Iradell son 26 b. Ga  
 Wm. B. son 23 "  
 M. Isabel dau 21 m. 1881 John Aldridge "  
 Thomas stepson 23 "

JOHN @ BRYAN son Wm. J. Bryan 187.  
 age 26  
 Caledonia (Walker) 15 (dau Son. Walton Walker)  
 Alice Walker (later) m. Mervin Kedaw MILLER

HENRY MILLER (WIFE SARAH SINGLETERY m 1835  
 Leon Co Fla) CLOSELY INVOLVED IN BOTH WM J. BRYAN &  
 ALEX SINGLETERY'S ESTATES)

Adjoining Martha Miller wid. Robt R. (p 7)

Name of Compiler G. W. Brunton  
 Address 120 Leatrice Lane  
 City, State Vicksburg MS. 39180  
 Date May 9, 1977

Person No. 1 on this chart is the same person as No. \_\_\_\_\_ on chart No. \_\_\_\_\_.

Chart No. \_\_\_\_\_

Date of Birth  
 Place of Birth  
 Date of Marriage  
 Date of Death  
 Place of Death

4 Franklin Jefferson Miller  
 (Father of No. 2)  
 b. May 12, 1856  
 p.b. THOS. CO. GA. (NOW GRADY)  
 m. Dec 1, 1889 2d.  
 d. Feb 17, 1940 1st wife: SARAH R. Sellers  
 p.d. GRADY CO. GA.

2 Vivick Palmer Miller  
 (Father of No. 1)  
 b. July 15, 1895  
 p.b. Grady Co (then THOS) GA  
 m. Dec 24, 1920, Cairo, Ga.  
 d. Sept 24, 1976  
 p.d. JACKSONVILLE, FLA.

5 Calissa Barbara Singletary  
 (Mother of No. 2)  
 b. Aug. 3, 1861  
 p.b. THOS. CO. GA (NOW GRADY)  
 d. Feb 16, 1931  
 p.d. GRADY CO, GA

1 Yvonne Kay Miller  
 b. Sept 27, 1921  
 p.b. LAKELAND, GA  
 m. Dec 24, 1941, Selma, Ala  
 d.  
 p.d.

6 John Henry Collins  
 (Father of No. 3)  
 b. Feb 27, 1869  
 p.b. THOS. CO (now GRADY)  
 m. Dec 24, 1888 91  
 d. Aug 27, 1953  
 p.d. GRADY CO, GA.

3 Eva Mae Collins  
 (Mother of No. 1)  
 b. March 25, 1896  
 p.b. THOS. CO GA (now GRADY)  
 d.  
 p.d.

7 Carrie Estella Cassels  
 (Mother of No. 3)  
 b. July 2, 1874  
 p.b. THOS. CO. (now GRADY)  
 d. July 27, 1952  
 p.d. GRADY CO. GA, Cairo

Dr. Adam S. Brunton  
 (Spouse of No. 1)  
 b. Apr 8, 1920 d.  
 p.b. Peebles, Scotland p.d.

8 John Jefferson Miller  
 (Father of No. 4)  
 b. April 24, 1836  
 p.b. LEON? FLA.  
 m. Dec 19, 1854 THOS. CO GA  
 d. May 23, 1864  
 p.d. THOS. CO, d. CSA

9 Louisa Eliza Baggett  
 (Mother of No. 4)  
 b. Nov 4, 1834  
 p.b. THOS. CO GA (Now Grady)  
 d. Nov 30, 1931  
 p.d. GRADY CO. GA

10 Willis Singletary  
 had bro Ben's. BRYAN SINGLETARY  
 b. 1832 TX.  
 p.b. LEON CO, FLA  
 m. Dec 20, 1855  
 d. July 1864  
 p.d. d. CSA, Augusta GA, COM

11 Narcissus Rawls  
 (Mother of No. 5)  
 b. May 3, 1835  
 p.b. THOS. CO. GA (now Grady)  
 d. Feb 16, 1913  
 p.d. GRADY CO.

12 Malachi Collins  
 (Father of No. 6)  
 b. Sept 8, 1831  
 p.b. Decatur Co. Ga (now Grady)  
 m. Dec 20, 1855  
 d. Jan 9, 1909  
 p.d. GRADY THOS. Co. Ga. (now Grady)

13 Ethia Sellers  
 (Mother of No. 6)  
 b. May 2, 1835  
 p.b. THOS. CO. (now Grady)  
 d. Nov 18, 1913,  
 p.d. GRADY CO.

14 Samuel Cassels  
 (Father of No. 7)  
 b. Feb 10, 1846  
 p.b. Decatur Co. Ga (now Grady)  
 m. Feb 3, 1867  
 d. Sept 14, 1891  
 p.d. THOS. CO (now GRADY)

15 Mary Sasser  
 (Mother of No. 7)  
 b. Jan 9, 1850  
 p.b. Decatur Co. (now GRADY)  
 d. April 20, 1915  
 p.d. GRADY CO. GA

16 Henry Miller  
 b. c 1805 THOS. CO GA (Father of No. 8,  
 m. Apr. 17, 1835, LEON, FLA Cont. on chart No. AL

17 Sarah Singletary  
 (Mother of No. 8,  
 Cont. on chart No. AL  
 b. c 1866-67 THOS CO, GA now  
 d. THOS CO, GA. Son El

18 Peter T. Baggett  
 b. 1800-1810 N.C. (Father of No. 9,  
 m. July 9, 1828 THOS. CO. GA Cont. on chart No.  
 d. THOS. CO. GA 1849

19 Thebe Chesnut  
 (Mother of No. 9,  
 Cont. on chart No. AL  
 b. c. 1806 N.C.  
 d. Nov. 2, 1896, THOS. CO. GA

20 Brayton Singletary  
 b. 1795 BLENDOENCO, N.C. (Father of No. 10,  
 m. N.E. c 1820 N.C. Cont. on chart No.  
 d. 1853 THOS. CO. GA  
 JULY 18th

21 Willis Singletary  
 (Mother of No. 10,  
 Cont. on chart No. AL  
 b. N.C.  
 d. FLA 1855

22 Wm. Henry Rawls  
 (Father of No. 11,  
 Cont. on chart No. AL  
 b. Feb 18, 1801, SC.  
 m. c 1825, SC.  
 d. March 27, 1877 THOS. CO.

23 Mahana Wells  
 (Mother of No. 11,  
 Cont. on chart No. AL  
 b. July 28, 1807  
 d.

24 Elizabeth Collins  
 (Father of No. 12,  
 Cont. on chart No. AL  
 b. July 6, 1807 GA  
 m. May 23, 1829 DEC. CO GA  
 d. Oct 26, 1872 THOS. CO.

25 Mary McCraw  
 (Mother of No. 12,  
 Cont. on chart No. AL  
 b. Nov 4, 1805, BURKE GA  
 d. Oct 5, 1890, THOS. CO. GA (now C)

26 Senieon Sellers  
 (Father of No. 13,  
 Cont. on chart No. AL  
 b. 1800-1810 N.C.  
 m. Dec 21, 1828 GA THOS. CO.  
 d. 1842 THOS. CO. GA

27 Lutha G. Lewis  
 (Mother of No. 13,  
 Cont. on chart No. AL  
 b. 1800-1810 S.C.  
 d. GA. Son

28 Rev. Wm. Henry Cass  
 (Father of No. 14,  
 Cont. on chart No. AL  
 b. Sept 22, 1797 W.A. CO  
 m. 1845 DEC. CO. (now GRADY)  
 d. Sept 29, 1858, Dec. Co. GA

29 Mary Caroline Cooper (wid) C  
 (Mother of No. 14,  
 Cont. on chart No. AL  
 b. 1815 S.C.  
 d. 1893, Dec. Co. GA.

30 Littleton Sasser  
 (Father of No. 15,  
 Cont. on chart No. AL  
 b. 1817, SC  
 m. 1845 prob. Dec. Co. GA  
 d. Feb 25, 1893 Dec. Co. GA

31 Zelpha M. Crow  
 (Mother of No. 15,  
 Cont. on chart No. AL  
 b. July 13, 1820, GA.  
 d. June, 1873, Dec Co (now C)

Compiler G. W. Brunton

sb 120 Leatrice Lane

State Vicksburg MS, 39180

Date May 9, 1977

Person No. 1 on this chart is the same person as No. \_\_\_\_\_ on chart No. \_\_\_\_\_

Chart No. \_\_\_\_\_

Date of Birth  
Place of Birth  
Date of Marriage  
Date of Death  
Place of Death

4 Franklin Jefferson Miller  
(Father of No. 2)

b. May 12, 1856  
p.b. THOS. CO. GA. (NOW GRADY)  
m. Dec 1, 1889 2d.  
d. Feb 17, 1940 1st wife:  
p.d. GRADY CO. GA. SARAH R. Sellers

2 Vivick Palmer Miller  
(Father of No. 1)

b. July 15, 1895  
p.b. Grady Co (then THOS) GA  
m. Dec 24, 1920, Cairo, Ga.  
d. Sept 24, 1976  
p.d. JACKSONVILLE, FLA.

5 Calissa Barbara Singletary  
(Mother of No. 2)

b. Aug 3, 1861  
p.b. THOS. CO. GA (NOW GRADY)  
d. Feb 16, 1931  
p.d. GRADY CO, GA

1 Gronne Kay Miller

b. Sept 27, 1921  
p.b. LAKELAND, GA  
m. Dec 24, 1941, Selma, Ala.  
d.  
p.d.

8 Solu Henry Collins  
(Father of No. 3)

b. Feb 27, 1869  
p.b. THOS. CO (now Grady)  
m. Dec 24, 1899  
d. Aug 27, 1953  
p.d. GRADY CO, GA.

3 Eva Mae Collins  
(Mother of No. 1)

b. March 25, 1896  
p.b. THOS. CO GA (now Grady)  
d.  
p.d.

7 Carnie Estella Cassels  
(Mother of No. 3)

b. July 2, 1874  
p.b. THOS. CO. (now Grady)  
d. July 27, 1952  
p.d. GRADY CO. GA, Cairo

Dr. Adam S. Brunton  
(Source of No. 1)

b. Apr 8, 1920 d.  
p.b. Peebles, Scotland p.d.

8 Solu Jefferson Miller  
(Father of No. 4)

b. April 24, 1836  
p.b. LEON? FLA.  
m. Dec 19, 1854 THOS. CO GA  
d. May 23, 1864  
p.d. THOS. CO, d. CSA

9 Lucas Eliz. Baggett  
(Mother of No. 4)

b. Nov 4, 1834  
p.b. THOS. CO GA (Now Grady)  
d. Nov 30, 1931  
p.d. GRADY CO. GA

10 Willis Singletary

had bro Ben's. BRYAN SINGLETARY  
1832 TO TX.  
b. LEON CO, FLA  
m. Dec 20, 1855  
d. July 1864  
p.d. d. CSA, Augusta GA, COM

11 Naveissus Rawls  
(Mother of No. 5)

b. May 3, 1835  
p.b. THOS. CO. GA (now Grady)  
d. Feb 16, 1913  
p.d. GRADY CO.

12 Malachi Collins  
(Father of No. 6)

b. Sept 8, 1831  
p.b. Decatur Co. Ga (now Grady)  
m. Dec 20, 1855  
d. Jan 9, 1909  
p.d. GRADY THOS. Co. Ga. (now Grady)

13 Etiza Sellers  
(Mother of No. 6)

b. May 2, 1835  
p.b. THOS. CO. (now Grady)  
d. Nov 18, 1913,  
p.d. GRADY CO.

14 Samuel Cassels  
(Father of No. 7)

b. Feb 10, 1846  
p.b. Decatur Co. Ga (now Grady)  
m. Feb 3, 1867  
d. Sept 14, 1891  
p.d. THOS. CO (now GRADY)

15 Mary Sasser  
(Mother of No. 7)

b. Jan 9, 1850  
p.b. Decatur Co. (now Grady)  
d. April 20, 1915  
p.d. GRADY CO. GA

16 Henry Miller

b. c 1805 N.E. GA (Father of No. 1,  
m. Apr. 17, 1835, LEON, FLA  
Cont. on chart No. \_\_\_\_\_

17 Sarah Singletary  
(Mother of No. 8,  
Cont. on chart No. \_\_\_\_\_

b. c 1796 N.C.  
d. THOS. CO, GA. Son Elias :

18 Peter T. Baggett  
(Father of No. 9,  
Cont. on chart No. \_\_\_\_\_

b. 1600-1810 P.C.  
m. July 9, 1828 THOS. CO. GA  
d. THOS. CO. GA c 1849

19 Phoebe Chesnut  
(Mother of No. 9,  
Cont. on chart No. \_\_\_\_\_

b. c. 1806 N.C.  
d. Nov. 2, 1896; THOS. CO. GA

20 Brayton Singletary  
(Father of No. 10,  
Cont. on chart No. \_\_\_\_\_

b. 1795 BLADEN CO, N.C.  
m. N.E. c 1820 Nol.  
1853 THOS. CO. GA  
JULY 12th

21 Phoebe Chesnut  
(Mother of No. 10,  
Cont. on chart No. \_\_\_\_\_

b. N.C.  
d. FLA ~~1855~~

22 Wm. Henry Rawls  
(Father of No. 11,  
Cont. on chart No. \_\_\_\_\_

b. Feb 18, 1801, S.C.  
m. c 1825, S.C.  
d. March 27, 1877 THOS. CO.

23 Mahana Wells  
(Mother of No. 11,  
Cont. on chart No. \_\_\_\_\_

b. July 28, 1807  
d.

24 Ezekiel Collins  
(Father of No. 12,  
Cont. on chart No. \_\_\_\_\_

b. July 6, 1807 GA  
m. May 23, 1829 DEC. CO GA  
d. Oct 26, 1872 THOS. CO. ~~DEATH~~

25 Mary McCrow  
(Mother of No. 12,  
Cont. on chart No. \_\_\_\_\_

b. Nov 4, 1805, BURKE GA  
d. Oct 5, 1890, THOS. CO. GA (now GRADY)

26 Samuel Sellers  
(Father of No. 13,  
Cont. on chart No. \_\_\_\_\_

b. 1800-1810 N.C.  
m. Dec 21, 1828 CA THOS. CO.  
d. 1842 THOS. CO. GA

27 Lutha G. Lewis  
(Mother of No. 13,  
Cont. on chart No. \_\_\_\_\_

m. 1845 15 year william  
b. 1800-1810 S.C.  
d. GA. Son Elias

28 Rev. Wm. Henry Cassels  
(Father of No. 14,  
Cont. on chart No. \_\_\_\_\_

b. Sept 27, 1797 LIA. CO  
m. 1845 DEC. CO. (now Grady)  
d. Sept 29, 1858, Dec. Co. GA

29 Mary Caroline Cooper  
(Mother of No. 14,  
Cont. on chart No. \_\_\_\_\_

b. 1815 S.C.  
d. 1893, Dec. Co. GA. Son Elias

30 Littleton Sasser  
(Father of No. 15,  
Cont. on chart No. \_\_\_\_\_

b. 1817, SCHEVEN CO (Father of No. 15,  
m. 1845 prob. Dec. Co. GA  
d. Feb 25, 1893 Dec. Co. GA

31 Zelpha M. Crow  
(Mother of No. 15,  
Cont. on chart No. \_\_\_\_\_

b. July 13, 1820, GA.  
d. June, 1873, Dec Co (now GRADY)



In the Name of God Amen the fourth Day of July in the year of our Lord one thousand seven hundred and seventy two, I, Joseph Singletary of the County of Bladen and Province of North Carolina Being of perfect Mind and Memory and understanding do make and ordain this my Last Will and Testament &c

Imprimisses: It is my will and I do order that in the first place all my just debts and Funeral charges be first paid and satisfied.

Item: It is my will and desire that my children shall be scholled out of my whole estate what ever my Executors hereafter mentioned shall think sufficient.

Item: It is my will and desire that my Beloved wife Mary Singletary enjoy my whole estate both read and personal during her widowhood except the schooling of the children but in case she marryes that immediately after that she is to have one third part of all the remainder or my moveable or personal estate laid off to her by my Executors hereafter mentioned to her and her Heirs and assigns forever.

Item: It is my Will and desire the other two thirds of my personal estate likewise all my real estate be equally divided amongst my children when the youngest arrives to the age of fourteen years old But in case their mother is then living in widowhood then the real estate <sup>is to</sup> be devided while she remains in that state to them their Heirs, Executors, Administrators and assigns forever.

And I do hereby utterly disallow, revoke and disannul all other former wills by me made, and I do declare this and no other to be my Last Will and Testament and I do hereby nominate, ordain and appoint my two brothers, Benjamin Fitzrandolph and Ithamar Singletary to be my true and lawful and whole Executors of this my last will and testament.

In witness whereof I have hereunto set my hand and seal the Day and Year first within written.

Joseph Singletary (Seal)

Signed, sealed, published, pronounced and declared by the Testator to be his Last Will and Testament in the presence of the subscribers who subscribed our names in the presence of the Testator.

John Poynter  
Mary Pounter  
Brayton Singletary

North Carolina }  
Bladen County } November Court 1772

Be it remembered that the Execution of the original Will was proved in open Court by the oath of John Poynter who swore that he did see Joseph Singletary sign, seal, publish and declare this to be his last will & testament & at the same time Mary Poynter & Braton Singletary signed concurring evidence thereto.

Test: Maturin Colvill, C.C.

North Carolina.  
By His Excellency JOSIAH MARTIN, ESQ:  
His Majesty's Captain-General, and Governor in Chief, in and over the said Province.

It being certified unto Me, That Joseph Singletary late of Bladen County, in this Province, is dead, and hath made his Last Will and Testament in writing thereby appointing Benjamin Fitzrandolph and Ithemar Singletary Executors thereof who Qualified before the Justices of the inferior Court of Bladen County by taking the oath

(Balance of page missing).

NORTH CAROLINA, BLADEN COUNTY:  
I, Smithy S. Harris, Clerk of the Superior Court of the aforesaid county and state do hereby certify that the foregoing will of Joseph Singletary is duly recorded in Will Book 2, page 505, et seq, Bladen County. Witness my hand and official seal, this the 13th day of May, 1980.

Smithy S. Harris  
Clerk Superior Court

Benjamin Bingham  
200 N. Bladen  
Bladen  
Sept 22<sup>d</sup> 1766

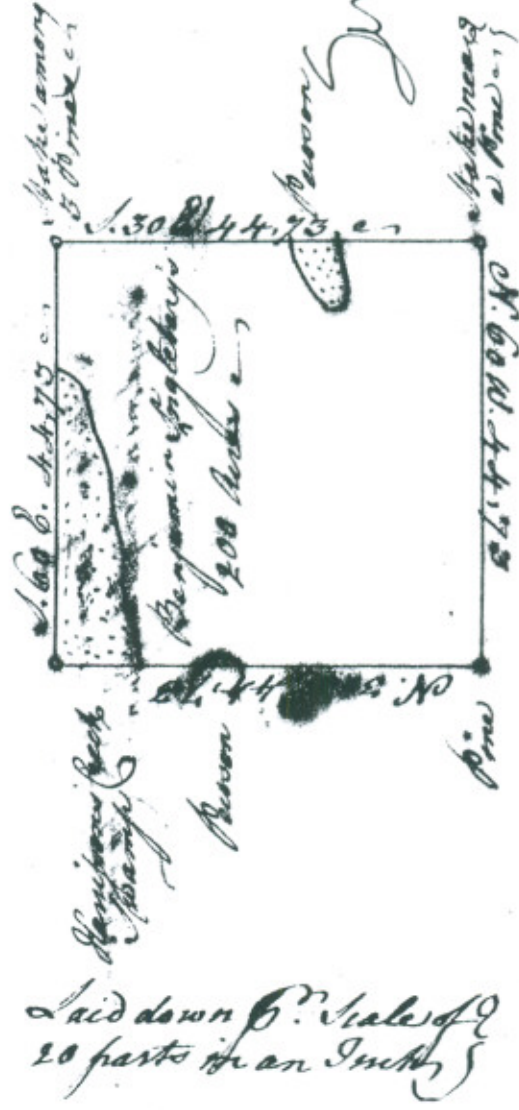

This Plot Represents Two Hundred Acres of Land in Bladen County on the N. E. of the N. W. Corner & W. side of Benning's Creek & is a square beginning on the south side of a shell Cyprus Pond at a Pine 40 paces from the N. E. corner of the plantation they are 60 p. 44.75 paces & 75 paces to a Stake among 3 Pines then 130 paces to the N. E. corner to a Stake among 2 Pine then N. 60 p. to the beginning & are managed by Benjamin Bingham the 16<sup>th</sup> of October 1766

Bladen County Public Library  
Elizabethtown, N. C. 27837

No. 2070

County Bladen

Name Benjamin Bingham

Acres 200

Grant No. 174

Issued 15<sup>th</sup> November 1771

Warrant No.

Entry No. 278

Entered 22<sup>nd</sup> Sept. 1766

Book No. 20

Page No. 74

Location On the N. side

of the N. W. corner

Ben. at an ash

Remarks:

over the said Province.

# To the Surveyor-General, GREETING:

**Y**OU are forthwith to admeasure and lay out, or cause to be admeasured and laid out, unto *Benjamin Singletary* a Plantation containing *two hundred* Acres of Land, in the County of *Bladen*

*upon the same to be taken out of the land of the late Geo. Willing & Co.*

Observing his Majesty's Instructions for running out Lands: Two just and fair Plans whereof, with a proper Certificate annexed to each, you are to return into the Secretary's Office, within Twelve Months from the Date hereof: AND if the Warrantee shall not, within Eighteen Months from the Date hereof, take out a Patent for the said Land, this Warrant, and all Proceedings thereon, shall be void and of no Force; and the said Land shall be deemed vacant, and free to be taken up by any other Person.

GIVEN at \_\_\_\_\_ under my Hand, the *22<sup>nd</sup>*  
Day of *September*, Annoque Domini, 1766

*Benjamin Singletary*

*Stephen Sumner*  
*Benjamin Singletary Junr*

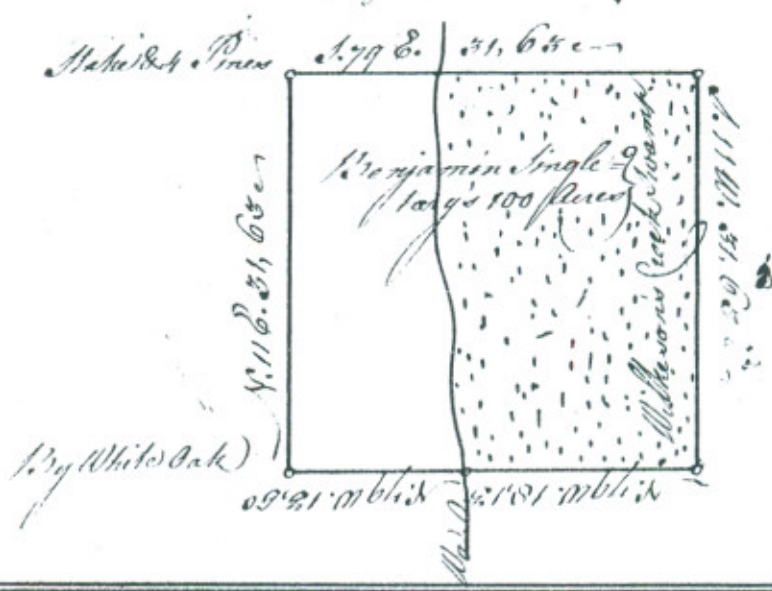

11 W. 31.68 E. - 11.8 W. - 18.18 W. - 18.18 W. - 4.79 E. - 31.68 E.

This Plot Represents One Hundred Acres of Land in Warden County  
 N. E. of the N.W. River on Willerson's <sup>side of</sup> Creek, beginning at  
 a Mark Oak in the Western Edge of said Swamp, in the back line of land  
 formerly patented by William Garner and from thence N. 79 W. 13  
 Chains and 30 Links by a White Oak then N. 11 E. 31 Chains & 65  
 Links to a Mark among 4 Pines Pointers then W. 89 E. 31 Chains and  
 65 Links then N. 11 W. 31 Chains and 65 Links then Direct to the be-  
 ginning Survey for Benjamin Singletary the 23 of June 1770  
 P. Edwards Survey

County Warden  
 Name Benjamin Singletary  
 Acres 100  
 Grant No. 73  
 Issued 18th September 1771  
 Warrant No. \_\_\_\_\_ Entry No. \_\_\_\_\_  
 Entered \_\_\_\_\_  
 Book No. 25 Page No. 214  
 Location at 21 of the 20  
links on the line  
from back swamp  
 Remarks: no present survey

REVOLUTIONARY SOLDIER JOSEPH SINGLETARY OF BLADEN COUNTY, N.C., WHO WENT TO  
FLORIDA-VICTIM OF ERRORS IN HIS RECORDS

From available records it is apparent that there were at least two men named Joseph Singletary who fought in the Revolution, among some 10 or 12 of their relatives.

In the North Carolina Colonial records, there is mention of an officer by the name of Joseph Singletary who made frequent appeals for compensation for the loss of the use of his arm. He seems to be heard from no more after about 1789, and cannot be identified in the 1790 census.

From the Abstracts of Wills of Bladen County, N.C., by Wanda Campbell, it is possible to piece together most of the family of Pvt. Joseph Singletary of the Bladen Militia, whose U. S. Pension Application Number was S-47849.

There is some confusion about this man, and he has been the victim of at least two errors in his records. When one sees the actual photocopy, these mistakes are easily understood. Pvt. Joseph Singletary's pension application was made at the April term of the Leon Co., Territory of Florida, Court of 1833. There is an error in the first publication of his record on this date, given as 1844. Joseph had bought land in Leon Co. in February of 1830, after arriving from North Carolina by way of Baker Co., GA, where he was in 1827, according to his deposition.

In his deposition he states that he is "about" 71 years and 10 months old, and was a resident of Bladen Co., N.C. In his Florida record of payments No. 29037, Book E., Vol 8, p. 138, they list him as being from South Carolina, although the names of his officers are those of his North Carolina Unit - Captain Joseph Andrews and Col. (later General) Thomas Brown. Later he was under Jared Irvin. 2

In the Index of Revolutionary War Pension applications, National Genealogical Society, 1966, Joseph is named as Singleton even though his Pension No. was correct. This may have come about since in at least one place in the General Services Administration Records, he is named "Singletary or Singleton". Of course, if one leaves the "y" off of Singletary, it does appear as Singleton. In some places he is referred to as Joseph Singletary Jr. Pvt. Joseph Singletary, b. Bladen Co. June 9, 1761, was a brother to Josiah Singletary b. Bladen Co. 1753, who fought in the same engagements, and was also wounded at Rockfish Creek June 6, 1781. They were sons of Joseph Singletary who died in Bladen Co., N.C. in 1772.

<sup>R.S.</sup>  
Ithamar Singletary<sup>A</sup> was their cousin and his father, Ithamar, was their uncle

and brother to Joseph, their father. Both Josiah and Ithamar fought as substitutes for their uncle, Benjamin Fitzrandolph. Joseph fought in the place of William Harrison.

In Josiah Singletary's Deposition, made in February of 1833, in Bladen Co., N.C., he states that the exact record of his age was in his brother's possession <sup>in Florida,</sup> "where he now resides".

In doing research on the Singletary family in Florida and Georgia, and after finding Joseph Singletary to be a victim of numerous mistakes, I became very interested in him.

My deductions from this point may be incorrect, but heretofore can be easily proved.

The first census in which Joseph is identifiable is the 1800 Bladen Co. census, p. 147. Joseph Singletary: 3 m not 10, 1 m 26-45, 2 f not 10, ~~1 f 10-16~~ 1 f 26-45. In 1810, p. 197, Joseph Singletary: 2 m not 10, 1 m 10-16, 1 m over 45, 4 f not 10, 1 f 10-15, 2 f 16-25, 1 f over 45. At this point, there were obviously others living in the house with them.

In the 1820 Bladen Co. Census, Joseph cannot be found. The exodus had already begun, so perhaps Joseph was already on his way, or in Baker Co., GA, where he states that he was in 1827.3

He appears in the Leon Co., FLA, Census of 1830. His son Nathaniel also appears as Head of Household, with his own family. Joseph: 1 m 10-15, 1 m 20-30, 1 m 30-40, 1 m 60-70, 1 f 15-20, 3 f 20-30.

Nathaniel: 2 m under 5, 1 m 5-10, 2 m 20-30, 1 f 20-30.

On the 7th of May 1836, Joseph Singletary sold his land in Leon Co., FLA, on May 18, 1836, Henry, his son, sold his land in Leon Co. and the following January, Nathaniel too sold out and went to Georgia.4

On May 21, 1836, 13 days after Joseph sold his Florida property, Josiah Singletary bought land in Thomas County, GA. There is no record of Joseph Singletary owning any land in Georgia, and since Josiah was his oldest son and had lived with him in Florida, it seems obvious that they all moved to Thomas County. By 1837, almost all the Singletary families in Florida had moved to Thomas County, presumably because of the terrible Indian Wars.5

In the 1840 Census, Nathaniel appears in adjoining Decatur County, GA, but by 1850 he too was in Thomas.

In the 1840 Thomas Co. census, Joseph is still the head of household: 1 m 5-10, (John, son of Josiah and W. Nancy) 1 m 20-30 (William) 1 m 40-50 (Josiah), 1 m 70-80 (Joseph), 1 f 30-40 most likely Mary (Ann) who nursed Joseph and who may also have been his daughter, 1 f 40-50, Nancy, wife of Josiah.